



Coriolis® COMPACT



Portable Dry Cyclonic Air Sampler

- Concentrated sample compatible with any downstream analysis
- Light & compact for indoor & outdoor use
- High efficiency with up to 8 hours of autonomy

Coriolis[®] COMPACT



Portable dry air sampler for bio contamination control:

The Coriolis[®] Compact is a dry cyclonic collector intended for microbial air monitoring. Light and compact, it can be easily transported and positioned on strategic places for **indoor and outdoor sampling**. Its **innovative dry cyclonic technology** aspirates the particles with an airflow of 50L/m & centrifuges them in a cone. The collected particles or microorganisms can then be recovered by rinsing consumable with appropriate buffer solution, so **the sample is compatible with multiple downstream analysis** (NGS, qPCR, Culture). The Coriolis[®] Compact gives access to **highly sensitive and specific results in only a few hours**.

Due to an improved battery autonomy, it performs up to **8 hours of continuous sampling**. Bertin provides single use consumable to avoid cross contamination.

Applications:



Pollution & Environment



Food / Pharma / Veterinary / Industry



Biomedical & Health



Research & Development

Innovative dry cyclonic technology:

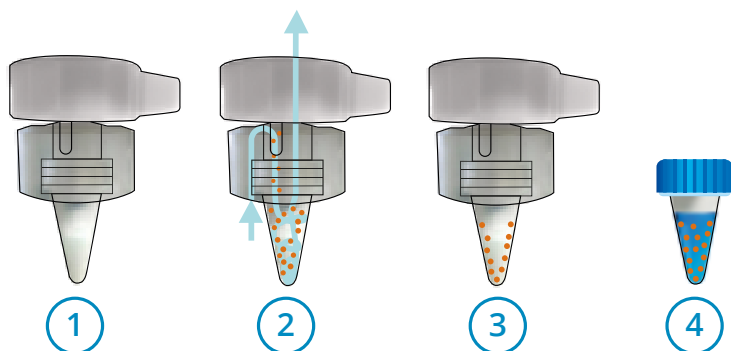

1. The cone is placed on the device and locked
2. Aspirated air runs into the cone & forms a vortex
3. Particles in the air are centrifuged in the cone's walls
4. Collected particles are recovered by rinsing the cone.



Technical features

DIMENSIONS

255x135x130 mm.

WEIGHT

1.2 kg. (battery included)

COLLECTION TIME

From 1 minute to 8 hours

TEMPERATURE RANGE

+5°C to +45°C
with a humidity range of 10% to 90%

FLOW

50 L./min.

SIZE OF PARTICLES COLLECTED

From 500 nm. to 10 µm.

TYPE OF PARTICLES COLLECTED

Bacteria, viruses, molds...

AUTONOMY ON BATTERY

Max 8 hours in operation at 20°C

DECONTAMINATION

H₂O₂

CATALOGUE REFERENCE

P002114-CORC0-A.0

Bertin's Life Sciences Solutions

